

## IGP 101

- Only 0,6 sec removal time by means of fast servo swivel drive
- Compact design
- Completely integrated into the injection mould machine

Axis	Description	Value	V max.
X	Removal stroke	50 mm	0,5 m/s
A	Swivel angle	360° Arm length 180 mm	1000°/s



## Technical specifications

- A-axis with EC servo motor, X-axis pneumatically driven
- Part and gripper weight together approx.: up to 0,5 kg
- Mains voltage: 230/115 V (50/60 Hz)
- Power rating: ca. 100 VA
- Compressed air supply: 6 bar
- Vacuum circuit or compressed air circuit
- Easy programming
- All Euromap 67 signals
- Adapter for Euromap 12 signals

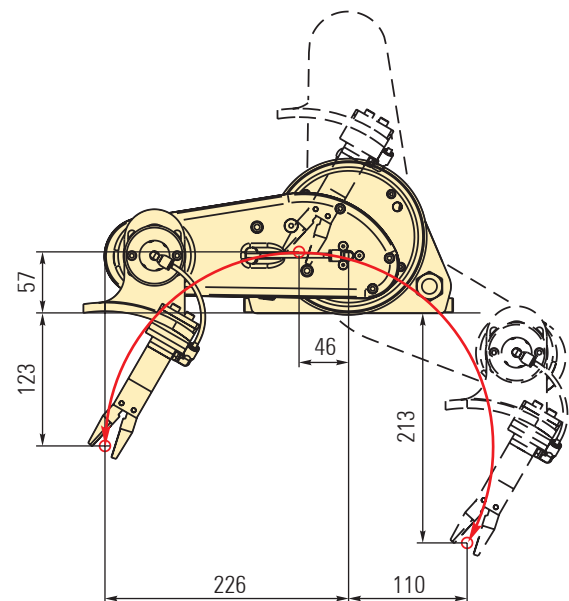
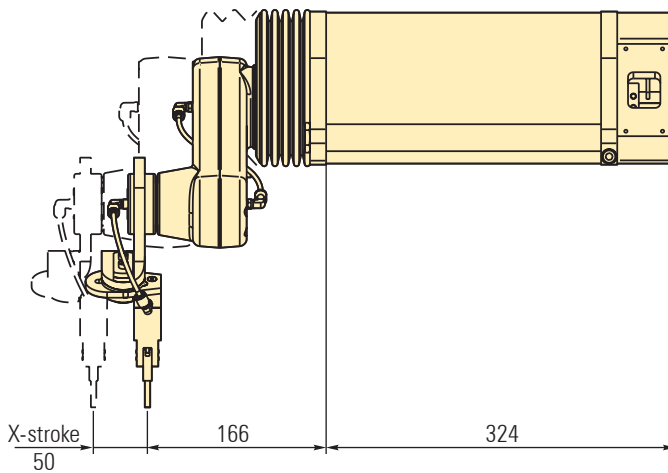

All data subject to change. Specifications and images for information purposes only.